

ONLINE REAL ESTATE AUCTION



**IT'S HERE IN
RENSSELAER**
EXPLORE RENSSELAER COUNTY

**SINGLE FAMILY, MULTI-FAMILY,
MANUFACTURED HOUSING,
RURAL & RESIDENTIAL VACANT LAND**

66+ RENSSELAER COUNTY, NY - TAX FORECLOSED PROPERTIES

BEGINS ONLINE: FRIDAY, NOVEMBER 21, 2025

REGISTRATION CLOSES: TUESDAY, DECEMBER 16, 2025, 1:00 PM

BIDS BEGIN CLOSING: THURSDAY, DECEMBER 18, 2025, 11:00 AM (ET)

SEE WEBSITE FOR COMPLETE DETAILS AND BIDDER REGISTRATION APPLICATION

REGISTER ONLINE AT www.CollarCityAuctions.com

LOT #22A, 428 OLD RD, TOWN/CITY OF GRAFTON CLASS CODE: 210, SINGLE FAMILY RESIDENCE

SBL: 84.-1-23

Lot Size: 0.86 +/- Acres

School District: Berlin Central

Assessed Value: \$72000

Town & County Taxes: \$2170

NOTE: Taxes DO NOT include re-levies.

Inspection: Drive by Anytime



LOT #71, 1110 WASHINGTON AVE, TOWN/CITY OF RENSSELAER CLASS CODE: 210, SINGLE FAMILY RESIDENCE

SBL: 133.82-10-2

Lot Size: 0.14 +/- Acres

School District: Rensselaer City

Assessed Value: \$30000

Town & County Taxes: \$4980

NOTE: Taxes DO NOT include re-levies.

Inspection: Drive by Anytime



LOT #84, 87 MOREY PARK RD, TOWN/CITY OF SCHODACK CLASS CODE: 210, SINGLE FAMILY RESIDENCE

SBL: 190.4-5-2

Lot Size: 0.25 +/- Acres

School District: East Greenbush Central

Assessed Value: \$88000

Town & County Taxes: \$2750

NOTE: Taxes DO NOT include re-levies.

Inspection: Drive by Anytime

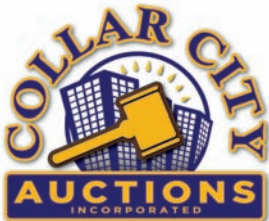

COLLAR CITY AUCTIONS

Licensed & Bonded Auctioneers * Liquidators * Realtors * Certified Appraisers * Consultants

(518) 895-8150 x 3003

CollarCityAuctions.com

Worldwide Auction, Liquidation, Real Estate, Appraisal, Consulting & Mgmt. Services

Members of: National Auctioneers Association, New York State Auctioneers Association, Realtor, Capital Region Multiple Listing Services, Greater Capital Association of Realtors, Certified Appraisers Guild of America, International Society of Appraisers, National Association of Bankruptcy Trustees, OBAB, National Association of Realtors, New York State Association of Realtors, Vermont Auctioneers Association, Massachusetts Auctioneers Association. Any and all information contained herein has been obtained from sources deemed reliable. Collar City Auctions, Inc. or the County of Rensselaer and any agents, employees, or sub-agents shall not be responsible for any errors or omissions or technology issues that may arise now or in the future. Hold Harmless shall apply in all matters. Subject to Change Without Notice. Buyer's must complete all their own due diligence prior to bidding. No bids may be withdrawn. Offer void where prohibited.



WELCOME TO RENSSELAER COUNTY

Discover the many treasures of beautiful Rensselaer County. From biking, hiking, kayaking and swimming to cross country skiing and snow shoeing, we've got you covered with miles of trails, nature preserves and three state parks.

Buying local takes on a new twist with fresh local products offered year-round at the [Troy Waterfront Farmers Market](#). Pick your own, farmers markets and farm stands abound during the summer and early fall. Summer highlights include free concert offerings throughout the county. Troy's [Rockin' on the River](#) concert series runs every Wednesday from mid-June to mid-August and provides the perfect start to a fun evening in Troy. Explore Troy the last Friday of every month for special programs and discounts in our unique boutiques and enjoy the culinary excellence at our many restaurants.

Nothing says summer like a baseball game with the [Tri-City Valley Cats](#) from June to September. Feeling nostalgic? Catch a movie under the stars and one of Rensselaer County's two drive-in theaters.

Get up close to history with tours, exhibits and programming at many of our historic sites. With changing exhibits and walking tours, make the [Rensselaer County Historical Society](#) your first stop. Interested in Dutch heritage then check out [Crailo State Historic Site](#). Join in a walking tour at [Oakwood Cemetery](#) (where Uncle Sam is buried) and discover history as you've never known it. For those who prefer the arts, Rensselaer County boasts many art venues with the world renowned acoustically perfect [Troy Savings Bank Music Hall](#) where you can enjoy an evening of music, comedy and more in an intimate setting. A mixture of architecture and performance arts can be found at the [EMPAC](#) center on the RPI Campus. Looking for alternative arts? Check out the [Sanctuary for Independent Media](#) in Troy. Enjoy award winning productions that can be seen at the [Sand Lake Center for the Arts](#) or the [Sage Theater Institute](#). Bring out the artist in you with a class at [The Arts Center of the Capital Region](#).



TOWN CLERKS

- RENSSELAER COUNTY CLERK – 518-270-2880
- TOWN OF BERLIN – 518-658-2161
- TOWN OF BRUNSWICK – 518-279-3461
- TOWN OF EAST GREENBUSH – 518-477-7145
- TOWN OF GRAFTON – 518-279-3461
- TOWN OF HOOSICK – 518-686-4571
- TOWN OF NASSAU – 518-766-2343

- TOWN OF NORTH GREENBUSH – 518-283-4306
- TOWN OF PETERSBURGH – 518-658-3777
- TOWN OF PITTSTOWN – 518-753-4222
- TOWN OF POESTENKILL – 518-283-5119
- TOWN OF SAND LAKE – 518-674-2026
- TOWN OF SCHAGHTICOKE – 518-753-6100
- TOWN OF SCHODACK – 518-477-7590
- TOWN OF STEPHENTOWN – 518-733-9195

LOT #1, COLD SPRING RD (W OF), TOWN/CITY OF BERLIN
CLASS CODE: 311, RESIDENTIAL VACANT LAND

SBL: 109.-2-1.2
 Lot Size: 2.75 +/- Acres
 School District: Berlin Central
 Assessed Value: \$785

Town & County Taxes: \$100
 NOTE: Taxes DO NOT include re-levies.
 Inspection: LANDLOCKED



LOT #2, 2701 PLANK RD, TOWN/CITY OF BERLIN
CLASS CODE: 210, SINGLE FAMILY RESIDENCE

SBL: 130.1-8-4.1
 Lot Size: 1.14 +/- Acres
 School District: Berlin Central
 Assessed Value: \$15500

Town & County Taxes: \$1950
 NOTE: Taxes DO NOT include re-levies.
 Inspection: Drive by Anytime



LOT #3, SOUTHEAST HOLLOW RD, TOWN/CITY OF BERLIN
CLASS CODE: 311, RESIDENTIAL VACANT LAND

SBL: 130.-2-8.2
 Lot Size: 0.5 +/- Acres
 School District: Berlin Central
 Assessed Value: \$800

Town & County Taxes: \$100
 NOTE: Taxes DO NOT include re-levies.
 Inspection: Drive by Anytime



LOT #3A, PENNYROYAL LN, TOWN/CITY OF BRUNSWICK
CLASS CODE: 314, RURAL VACANT < 10 ACRES

SBL: 115.-2-7
 Lot Size: 1 +/- Acres
 School District: Brunswick Central
 Assessed Value: \$250

Town & County Taxes: \$50
 NOTE: Taxes DO NOT include re-levies.
 Inspection: LANDLOCKED



LOT #8, CAMEL HILL RD, TOWN/CITY OF BRUNSWICK
CLASS CODE: 314, RURAL VACANT < 10 ACRES

SBL: 83.-4-22
 Lot Size: 0.17 +/- Acres
 School District: Brunswick Central
 Assessed Value: \$2400

Town & County Taxes: \$300
 NOTE: Taxes DO NOT include re-levies.
 Inspection: Drive by Anytime

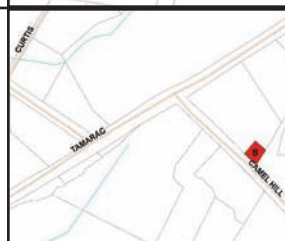

LOT #9, 850 LUTHER RD, TOWN/CITY OF EAST GREENBUSH
CLASS CODE: 210, SINGLE FAMILY RESIDENCE

SBL: 156.-3-42
 Lot Size: 0.67 +/- Acres
 School District: East Greenbush Central
 Assessed Value: \$177000

Town & County Taxes: \$3400
 NOTE: Taxes DO NOT include re-levies.
 Inspection: Drive by Anytime



LOT #12, STOCK LN (E OF), TOWN/CITY OF EAST GREENBUSH
CLASS CODE: 314, RURAL VACANT < 10 ACRES

SBL: 155.-2-20.12
 Lot Size: 0.37 +/- Acres
 School District: East Greenbush Central
 Assessed Value: \$13000

Town & County Taxes: \$350
 NOTE: Taxes DO NOT include re-levies.
 Inspection: LANDLOCKED



LOT #14, BEST LUTHER RD (W OF), TOWN/CITY OF EAST GREENBUSH
CLASS CODE: 314, RURAL VACANT < 10 ACRES

SBL: 168.-1-19
 Lot Size: 0.85 +/- Acres
 School District: East Greenbush Central
 Assessed Value: \$67500

Town & County Taxes: \$1500
 NOTE: Taxes DO NOT include re-levies.
 Inspection: LANDLOCKED



LOT #15, 7 ARIZONA AVE, TOWN/CITY OF EAST GREENBUSH
CLASS CODE: 210, SINGLE FAMILY RESIDENCE

SBL: 166.10-12-3

Lot Size: 0.14 +/- Acres

School District: East Greenbush Central

Assessed Value: \$224000

Town & County Taxes: \$4360

NOTE: Taxes DO NOT include re-levies.

Inspection: Drive by Anytime



LOT #22, BEHUNIAK RD (W OF), TOWN/CITY OF GRAFTON
CLASS CODE: 314, RURAL VACANT < 10 ACRES

SBL: 104.-1-14

Lot Size: 2.5 +/- Acres

School District: Brunswick Central

Assessed Value: \$9800

Town & County Taxes: \$310

NOTE: Taxes DO NOT include re-levies.

Inspection: LANDLOCKED



LOT #22A, 428 OLD RD, TOWN/CITY OF GRAFTON
CLASS CODE: 210, SINGLE FAMILY RESIDENCE

SBL: 84.-1-23

Lot Size: 0.86 +/- Acres

School District: Berlin Central

Assessed Value: \$72000

Town & County Taxes: \$2170

NOTE: Taxes DO NOT include re-levies.

Inspection: Drive by Anytime



LOT #24, 21229 NY 22, TOWN/CITY OF HOOSICK
CLASS CODE: 210, SINGLE FAMILY RESIDENCE

SBL: 37.-2-28

Lot Size: 0.42 +/- Acres

School District: Hoosick Falls Central

Assessed Value: \$122000

Town & County Taxes: \$3000

NOTE: Taxes DO NOT include re-levies.

Inspection: Drive by Anytime



LOT #26, 54 CLASSIC ST, VILLAGE OF HOOSICK FALLS TOWN/CITY OF HOOSICK
CLASS CODE: 311, RESIDENTIAL VACANT LAND

SBL: 27.15-2-13

Lot Size: 0.11 +/- Acres

School District: Hoosick Falls Central

Assessed Value: \$11800

Town & County Taxes: \$370

NOTE: Taxes DO NOT include re-levies.

Inspection: Drive by Anytime



LOT #27, 48 CLASSIC ST, VILLAGE OF HOOSICK FALLS TOWN/CITY OF HOOSICK
CLASS CODE: 311, RESIDENTIAL VACANT LAND

SBL: 27.15-2-14

Lot Size: 0.06 +/- Acres

School District: Hoosick Falls Central

Assessed Value: \$7000

Town & County Taxes: \$215

NOTE: Taxes DO NOT include re-levies.

Inspection: Drive by Anytime



LOT #28, 44 CLASSIC ST, VILLAGE OF HOOSICK FALLS TOWN/CITY OF HOOSICK
CLASS CODE: 311, RESIDENTIAL VACANT LAND

SBL: 27.15-2-15

Lot Size: 0.07 +/- Acres

School District: Hoosick Falls Central

Assessed Value: \$8000

Town & County Taxes: \$250

NOTE: Taxes DO NOT include re-levies.

Inspection: Drive by Anytime



LOT #29, CHURCH ST, VILLAGE OF HOOSICK FALLS TOWN/CITY OF HOOSICK
CLASS CODE: 311, RESIDENTIAL VACANT LAND

SBL: 27.15-2-20

Lot Size: 0.65 +/- Acres

School District: Hoosick Falls Central

Assessed Value: \$4300

Town & County Taxes: \$180

NOTE: Taxes DO NOT include re-levies.

Inspection: Drive by Anytime



LOT #29A, 260 TATE RD, TOWN/CITY OF HOOSICK
CLASS CODE: 210, SINGLE FAMILY RESIDENCE

SBL: 16.-2-4.2
 Lot Size: 3.28 +/- Acres
 School District: Hoosick Falls Central
 Assessed Value: \$180000

Town & County Taxes: \$4300
 NOTE: Taxes DO NOT include re-levies.
 Inspection: Drive by Anytime



LOT #29B, 6 SPRING ST, VILLAGE OF HOOSICK FALLS TOWN/CITY OF HOOSICK
CLASS CODE: 311, RESIDENTIAL VACANT LAND

SBL: 27.15-13-26
 Lot Size: 0.09 +/- Acres
 School District: Hoosick Falls Central
 Assessed Value: \$10000

Town & County Taxes: \$310
 NOTE: Taxes DO NOT include re-levies.
 Inspection: Drive by Anytime



LOT #29C, 167 CHURCH ST, VILLAGE OF HOOSICK FALLS TOWN/CITY OF HOOSICK
CLASS CODE: 210, SINGLE FAMILY RESIDENCE

SBL: 27.19-14-10
 Lot Size: 0.06 +/- Acres
 School District: Hoosick Falls Central
 Assessed Value: \$24000

Town & County Taxes: \$700
 NOTE: Taxes DO NOT include re-levies.
 Inspection: Drive by Anytime



LOT #29D, 2204 BUSKIRK WEST HOOSICK RD, TOWN/CITY OF HOOSICK
CLASS CODE: 210, SINGLE FAMILY RESIDENCE

SBL: 5.-2-7
 Lot Size: 0.43 +/- Acres
 School District: Cambridge Central
 Assessed Value: \$218000

Town & County Taxes: \$4970
 NOTE: Taxes DO NOT include re-levies.
 Inspection: Drive by Anytime



LOT #31, 58 HIGH ST, VILLAGE OF HOOSICK FALLS TOWN/CITY OF HOOSICK
CLASS CODE: 220, TWO FAMILY RESIDENCE

SBL: 27.11-2-21
 Lot Size: 0.43 +/- Acres
 School District: Hoosick Falls Central
 Assessed Value: \$124000

Town & County Taxes: \$3550
 NOTE: Taxes DO NOT include re-levies.
 Inspection: Drive by Anytime



LOT #32, 35 2ND ST, VILLAGE OF HOOSICK FALLS TOWN/CITY OF HOOSICK
CLASS CODE: 220, TWO FAMILY RESIDENCE

SBL: 27.19-2-15
 Lot Size: 0.16 +/- Acres
 School District: Hoosick Falls Central
 Assessed Value: \$117000

Town & County Taxes: \$3300
 NOTE: Taxes DO NOT include re-levies.
 Inspection: Drive by Anytime

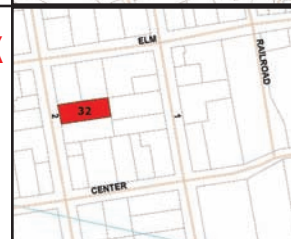

LOT #33, 4967 NY 67, TOWN/CITY OF HOOSICK
CLASS CODE: 281, MULTIPLE RESIDENCES

SBL: 18.-1-13.1
 Lot Size: 0.54 +/- Acres
 School District: Hoosick Falls Central
 Assessed Value: \$120600

Town & County Taxes: \$2950
 NOTE: Taxes DO NOT include re-levies.
 Inspection: Drive by Anytime



LOT #34, 19 5TH ST, VILLAGE OF HOOSICK FALLS TOWN/CITY OF HOOSICK
CLASS CODE: 230, THREE FAMILY RESIDENCE

SBL: 27.18-9-15
 Lot Size: 0.24 +/- Acres
 School District: Hoosick Falls Central
 Assessed Value: \$102000

Town & County Taxes: \$3100
 NOTE: Taxes DO NOT include re-levies.
 Inspection: Drive by Anytime



LOT #35, BOVIE HILL RD (N OF), TOWN/CITY OF HOOSICK
CLASS CODE: 314, RURAL VACANT < 10 ACRES

SBL: 37.-1-23.10
 Lot Size: 7.03 +/- Acres
 School District: Hoosick Falls Central
 Assessed Value: \$34600

Town & County Taxes: \$850
 NOTE: Taxes DO NOT include re-levies.
 Inspection: LANDLOCKED

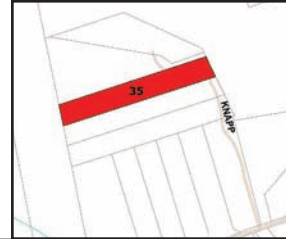

LOT #37, 35 SCOTT ST, TOWN/CITY OF HOOSICK
CLASS CODE: 210, SINGLE FAMILY RESIDENCE

SBL: 27.14-1-27
 Lot Size: 3.7 +/- Acres
 School District: Hoosick Falls Central
 Assessed Value: \$170000

Town & County Taxes: \$4200
 NOTE: Taxes DO NOT include re-levies.
 Inspection: Drive by Anytime



LOT #37A, 5 DUNDEE AVE, TOWN/CITY OF HOOSICK
CLASS CODE: 220, TWO FAMILY RESIDENCE

SBL: 27.-1-14
 Lot Size: 7.12 +/- Acres
 School District: Hoosick Falls Central
 Assessed Value: \$202000

Town & County Taxes: \$5100
 NOTE: Taxes DO NOT include re-levies.
 Inspection: Drive by Anytime



LOT #38, 30 3RD ST, VILLAGE OF HOOSICK FALLS TOWN/CITY OF HOOSICK
CLASS CODE: 270, MANUFACTURED HOME

SBL: 27.18-6-7
 Lot Size: 0.13 +/- Acres
 School District: Hoosick Falls Central
 Assessed Value: \$14100

Town & County Taxes: \$400
 NOTE: Taxes DO NOT include re-levies.
 Inspection: Drive by Anytime



LOT #39, 16 SCHOOL ST, VILLAGE OF HOOSICK FALLS TOWN/CITY OF HOOSICK
CLASS CODE: 311, RESIDENTIAL VACANT LAND

SBL: 27.14-6-1
 Lot Size: 0.34 +/- Acres
 School District: Hoosick Falls Central
 Assessed Value: \$11300

Town & County Taxes: \$350
 NOTE: Taxes DO NOT include re-levies.
 Inspection: Drive by Anytime



LOT #40, 23 DUNDEE AVE, TOWN/CITY OF HOOSICK
CLASS CODE: 210, SINGLE FAMILY RESIDENCE

SBL: 27.10-5-2.1
 Lot Size: 0.57 +/- Acres
 School District: Hoosick Falls Central
 Assessed Value: \$47000

Town & County Taxes: \$1200
 NOTE: Taxes DO NOT include re-levies.
 Inspection: Drive by Anytime

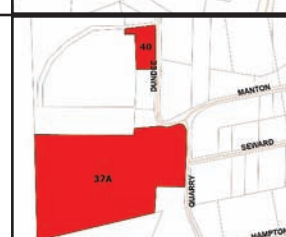

LOT #41, NORTH NASSAU LN, TOWN/CITY OF NASSAU
CLASS CODE: 314, RURAL VACANT < 10 ACRES

SBL: 181.-1-6
 Lot Size: 0.66 +/- Acres
 School District: Averill Park Central
 Assessed Value: \$3300

Town & County Taxes: \$150
 NOTE: Taxes DO NOT include re-levies.
 Inspection: Drive by Anytime



LOT #42, 3140 US 20, TOWN/CITY OF NASSAU
CLASS CODE: 311, RESIDENTIAL VACANT LAND

SBL: 212.-1-2
 Lot Size: 0.11 +/- Acres
 School District: East Greenbush Central
 Assessed Value: \$8000

Town & County Taxes: \$310
 NOTE: Taxes DO NOT include re-levies.
 Inspection: Drive by Anytime



LOT #42A, 2776 US 20, TOWN/CITY OF NASSAU
CLASS CODE: 433, AUTO BODY

SBL: 212.-1-53

Lot Size: 27.95 +/- Acres

School District: East Greenbush Central

Assessed Value: \$200000

Town & County Taxes: \$9100

NOTE: Taxes DO NOT include re-levies.

Inspection: Drive by Anytime

NOTE: Partial Wetlands



LOT #42B, 2708 US 20, TOWN/CITY OF NASSAU
CLASS CODE: 433, AUTO BODY

SBL: 212.-1-58

Lot Size: 0.77 +/- Acres

School District: East Greenbush Central

Assessed Value: \$50000

Town & County Taxes: \$2800

NOTE: Taxes DO NOT include re-levies.

Inspection: Drive by Anytime



LOT #45, CHURCH ST (REAR), VILLAGE OF NASSAU - NASSAU TOWN/CITY OF NASSAU
CLASS CODE: 311, RESIDENTIAL VACANT LAND

SBL: 212.9-1-4.2

Lot Size: 0.11 +/- Acres

School District: East Greenbush Central

Assessed Value: \$2500

Town & County Taxes: \$110

NOTE: Taxes DO NOT include re-levies.

Inspection: LANDLOCKED

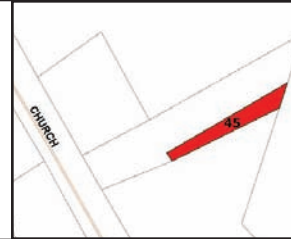

LOT #45A, 4 NICHOLAS AVE, TOWN/CITY OF NORTH GREENBUSH
CLASS CODE: 210, SINGLE FAMILY RESIDENCE

SBL: 134.17-3-28

Lot Size: 0.38 +/- Acres

School District: East Greenbush Central

Assessed Value: \$55200

Town & County Taxes: \$6400

NOTE: Taxes DO NOT include re-levies.

Inspection: Drive by Anytime



LOT #46, KUHLE BLVD (E OF), TOWN/CITY OF NORTH GREENBUSH
CLASS CODE: 311, RESIDENTIAL VACANT LAND

SBL: 124.14-8-5.23

Lot Size: 0.02 +/- Acres

School District: Wynantskill Union

Assessed Value: \$500

Town & County Taxes: \$260

NOTE: Taxes DO NOT include re-levies.

Inspection: LANDLOCKED

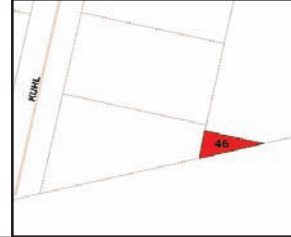

LOT #47, WHITEVIEW RD (S OF), TOWN/CITY OF NORTH GREENBUSH
CLASS CODE: 311, RESIDENTIAL VACANT LAND

SBL: 123.11-3-8.2

Lot Size: 0.38 +/- Acres

School District: Wynantskill Union

Assessed Value: \$5000

Town & County Taxes: \$800

NOTE: Taxes DO NOT include re-levies.

Inspection: LANDLOCKED



LOT #49, FRANKLIN AVE, TOWN/CITY OF NORTH GREENBUSH
CLASS CODE: 311, RESIDENTIAL VACANT LAND

SBL: 135.9-4-1

Lot Size: 0.13 +/- Acres

School District: Averill Park Central

Assessed Value: \$500

Town & County Taxes: \$175

NOTE: Taxes DO NOT include re-levies.

Inspection: Drive by Anytime



LOT #50, FRANKLIN AVE, TOWN/CITY OF NORTH GREENBUSH
CLASS CODE: 311, RESIDENTIAL VACANT LAND

SBL: 135.9-4-14

Lot Size: 0.12 +/- Acres

School District: Averill Park Central

Assessed Value: \$500

Town & County Taxes: \$175

NOTE: Taxes DO NOT include re-levies.

Inspection: Drive by Anytime



<p>LOT #52, NY 2, TOWN/CITY OF PETERSBURGH CLASS CODE: 312, RESIDENTIAL VACANT LAND W/ IMPROVEMENT</p> <p>SBL: 97.-1-53 Lot Size: 2.38 +/- Acres School District: Berlin Central Assessed Value: \$8200</p> <p>Town & County Taxes: \$400 NOTE: Taxes DO NOT include re-levies. Inspection: Drive by Anytime</p>		
<p>LOT #53, 48 MAIN ST, TOWN/CITY OF PETERSBURGH CLASS CODE: 311, RESIDENTIAL VACANT LAND</p> <p>SBL: 97.4-2-3 Lot Size: 0.07 +/- Acres School District: Berlin Central Assessed Value: \$1000</p> <p>Town & County Taxes: \$100 NOTE: Taxes DO NOT include re-levies. Inspection: Drive by Anytime</p>		
<p>LOT #54, 704 JONES HOLLOW RD, TOWN/CITY OF PETERSBURGH CLASS CODE: 311, RESIDENTIAL VACANT LAND</p> <p>SBL: 97.4-3-7 Lot Size: 2.84 +/- Acres School District: Berlin Central Assessed Value: \$65900</p> <p>Town & County Taxes: \$3300 NOTE: Taxes DO NOT include re-levies. Inspection: Drive by Anytime</p>		
<p><i>Lot 54 NOTE: Assessment Value and Property Taxes are based on the property being Class Code 210 (One Family Residential). Parcel is now possibly Class Code 311 (Residential Vacant Land). Contact Town Assessor to review Assessment Value and Property Taxes.</i></p>		
<p>LOT #55, 61 REYNOLDS RD, TOWN/CITY OF PETERSBURGH CLASS CODE: 210, SINGLE FAMILY RESIDENCE</p> <p>SBL: 87.-1-13.2 Lot Size: 1.41 +/- Acres School District: Berlin Central Assessed Value: \$43000</p> <p>Town & County Taxes: \$2100 NOTE: Taxes DO NOT include re-levies. Inspection: Drive by Anytime</p>		
<p>LOT #59, WOODVIEW RD, TOWN/CITY OF PITTSTOWN CLASS CODE: 314, RURAL VACANT < 10 ACRES</p> <p>SBL: 71.-4-11 Lot Size: 0.76 +/- Acres School District: Brunswick Central Assessed Value: \$3800</p> <p>Town & County Taxes: \$100 NOTE: Taxes DO NOT include re-levies. Inspection: Patrial LANDLOCKED</p>		
<p><i>Lot 59 NOTE: Will be sold with the adjoining lot 15 Mountain Way, Tax Map # 61.-2-60, located in the Town of Schaghticoke (.62AC). Assessed and taxed in the Town of Pittstown; Both lots are Permanent Open Spaces, Undevelopable and Water Retention Areas.</i></p>		
<p>LOT #60, NY 67 (OFF), TOWN/CITY OF PITTSTOWN CLASS CODE: 311, RESIDENTIAL VACANT LAND</p> <p>SBL: 23.-3-10.2 Lot Size: 2.07 +/- Acres School District: Hoosic Valley Central Assessed Value: \$10400</p> <p>Town & County Taxes: \$300 NOTE: Taxes DO NOT include re-levies. Inspection: Drive by Anytime</p>		
<p>LOT #61, 2330 NY 67, TOWN/CITY OF PITTSTOWN CLASS CODE: 210, SINGLE FAMILY RESIDENCE</p> <p>SBL: 23.-3-10.5 Lot Size: 2.44 +/- Acres School District: Hoosic Valley Central Assessed Value: \$156000</p> <p>Town & County Taxes: \$3650 NOTE: Taxes DO NOT include re-levies. Inspection: Drive by Anytime</p>		
<p>LOT #63, 3402 NY 7, TOWN/CITY OF PITTSTOWN CLASS CODE: 210, SINGLE FAMILY RESIDENCE</p> <p>SBL: 55.1-2-2 Lot Size: 0.32 +/- Acres School District: Brunswick Central Assessed Value: \$139000</p> <p>Town & County Taxes: \$3500 NOTE: Taxes DO NOT include re-levies. Inspection: Drive by Anytime</p>		

LOT #64, 55 MASON LN, TOWN/CITY OF PITTSTOWN**CLASS CODE: 270, MANUFACTURED HOME**

SBL: 63.3-2-5

Lot Size: 0.59 +/- Acres

School District: Brunswick Central

Assessed Value: \$51600

Town & County Taxes: \$1500

NOTE: Taxes DO NOT include re-levies.

Inspection: Drive by Anytime

**LOT #68, 317 SOUTH ST, TOWN/CITY OF RENSSELAER****CLASS CODE: 210, SINGLE FAMILY RESIDENCE**

SBL: 154.43-2-6

Lot Size: 0.36 +/- Acres

School District: Rensselaer City

Assessed Value: \$15000

Town & County Taxes: \$2500

NOTE: Taxes DO NOT include re-levies.

Inspection: Drive by Anytime

**LOT #69, 61 SOUTH ST, TOWN/CITY OF RENSSELAER****CLASS CODE: 210, SINGLE FAMILY RESIDENCE**

SBL: 154.28-2-9

Lot Size: 0.09 +/- Acres

School District: Rensselaer City

Assessed Value: \$16500

Town & County Taxes: \$2800

NOTE: Taxes DO NOT include re-levies.

Inspection: Drive by Anytime

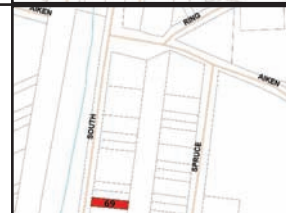
**LOT #70, 1624 BROADWAY, TOWN/CITY OF RENSSELAER****CLASS CODE: 210, SINGLE FAMILY RESIDENCE**

SBL: 133.77-5-14

Lot Size: 0.06 +/- Acres

School District: Rensselaer City

Assessed Value: \$12900

Town & County Taxes: \$2150

NOTE: Taxes DO NOT include re-levies.

Inspection: Drive by Anytime

**LOT #71, 1110 WASHINGTON AVE, TOWN/CITY OF RENSSELAER****CLASS CODE: 210, SINGLE FAMILY RESIDENCE**

SBL: 133.82-10-2

Lot Size: 0.14 +/- Acres

School District: Rensselaer City

Assessed Value: \$30000

Town & County Taxes: \$4980

NOTE: Taxes DO NOT include re-levies.

Inspection: Drive by Anytime

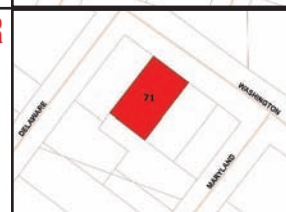
**LOT #72, 64 TOLL GATE RD, TOWN/CITY OF SAND LAKE****CLASS CODE: 210, SINGLE FAMILY RESIDENCE**

SBL: 147.1-2-65

Lot Size: 0.23 +/- Acres

School District: Averill Park Central

Assessed Value: \$174000

Town & County Taxes: \$3800

NOTE: Taxes DO NOT include re-levies.

Inspection: Drive by Anytime

**LOT #80, 351 HILLCREST ST, TOWN/CITY OF SCHAGHTICOKE****CLASS CODE: 210, SINGLE FAMILY RESIDENCE**

SBL: 70.15-2-55

Lot Size: 0.12 +/- Acres

School District: Lansingburgh Central

Assessed Value: \$26700

Town & County Taxes: \$4500

NOTE: Taxes DO NOT include re-levies.

Inspection: Drive by Anytime

**LOT #81, NY 40, VILLAGE OF SCHAGHTICOKE-SCHAGHTICOKE TOWN/CITY OF SCHAGHTICOKE****CLASS CODE: 311, RESIDENTIAL VACANT LAND**

SBL: 22.18-3-13

Lot Size: 0.72 +/- Acres

School District: Hoosic Valley Central

Assessed Value: \$100

Town & County Taxes: \$225

NOTE: Taxes DO NOT include re-levies.

Inspection: Drive by Anytime

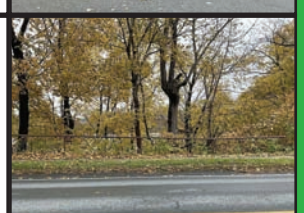
**LOT #84, 87 MOREY PARK RD, TOWN/CITY OF SCHODACK****CLASS CODE: 210, SINGLE FAMILY RESIDENCE**

SBL: 190.4-5-2

Lot Size: 0.25 +/- Acres

School District: East Greenbush Central

Assessed Value: \$88000

Town & County Taxes: \$2750

NOTE: Taxes DO NOT include re-levies.

Inspection: Drive by Anytime



LOT #87, 82 S MAIN ST, VILLAGE OF CASTLETON - SCHODACK TOWN/CITY OF SCHODACK**CLASS CODE: 220, TWO FAMILY RESIDENCE**

SBL: 198.15-1-42

Lot Size: 0.04 +/- Acres

School District: Schodack Central

Assessed Value: \$30100

Town & County Taxes: \$1700

NOTE: Taxes DO NOT include re-leivies.

Inspection: Drive by Anytime

**LOT #88, KRAFT RD, TOWN/CITY OF SCHODACK****CLASS CODE: 314, RURAL VACANT < 10 ACRES**

SBL: 178.-8-17

Lot Size: 0.8 +/- Acres

School District: East Greenbush Central

Assessed Value: \$30000

Town & County Taxes: \$915

NOTE: Taxes DO NOT include re-leivies.

Inspection: Drive by Anytime

**LOT #90, 112 SEAMAN AVE, TOWN/CITY OF SCHODACK****CLASS CODE: 210, SINGLE FAMILY RESIDENCE**

SBL: 199.13-1-16

Lot Size: 1.12 +/- Acres

School District: Schodack Central

Assessed Value: \$117000

Town & County Taxes: \$4750

NOTE: Taxes DO NOT include re-leivies.

Inspection: Drive by Anytime

**LOT #92, WASHINGTON AVE, TOWN/CITY OF SCHODACK****CLASS CODE: 311, RESIDENTIAL VACANT LAND**

SBL: 202.13-1-18

Lot Size: 0.08 +/- Acres

School District: East Greenbush Central

Assessed Value: \$2400

Town & County Taxes: \$100

NOTE: Taxes DO NOT include re-leivies.

Inspection: Drive by Anytime

**LOT #93, PHILLIPS RD (W OF), TOWN/CITY OF SCHODACK****CLASS CODE: 322, RESIDENTIAL VACANT LAND > 10 ACRES**

SBL: 188.-2-1.1

Lot Size: 52.7 +/- Acres

School District: East Greenbush Central

Assessed Value: \$37100

Town & County Taxes: \$1370

NOTE: Taxes DO NOT include re-leivies.

Inspection: LANDLOCKED

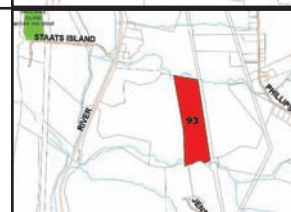
**LOT #93A, 16794 NY 22, TOWN/CITY OF STEPHENTOWN****CLASS CODE: 210, SINGLE FAMILY RESIDENCE**

SBL: 174.-1-6

Lot Size: 13.66 +/- Acres

School District: Berlin Central

Assessed Value: \$239000

Town & County Taxes: \$6000

NOTE: Taxes DO NOT include re-leivies.

Inspection: Drive by Anytime

**LOT #96, BLACK RIVER RD, TOWN/CITY OF STEPHENTOWN****CLASS CODE: 322, RESIDENTIAL VACANT LAND > 10 ACRES**

SBL: 184.-1-4.11

Lot Size: 11.72 +/- Acres

School District: Berlin Central

Assessed Value: \$37500

Town & County Taxes: \$950

NOTE: Taxes DO NOT include re-leivies.

Inspection: Drive by Anytime

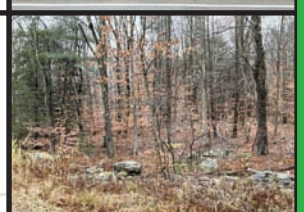
**LOT #98, NY 43, TOWN/CITY OF STEPHENTOWN****CLASS CODE: 322, RESIDENTIAL VACANT LAND > 10 ACRES**

SBL: 194.-1-26

Lot Size: 36.56 +/- Acres

School District: Averill Park Central

Assessed Value: \$75000

Town & County Taxes: \$2200

NOTE: Taxes DO NOT include re-leivies.

Inspection: LANDLOCKED

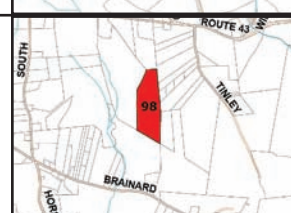
**LOT #99, 1142 NY 43, TOWN/CITY OF STEPHENTOWN****CLASS CODE: 311, RESIDENTIAL VACANT LAND**

SBL: 183.-1-20

Lot Size: 0.78 +/- Acres

School District: Berlin Central

Assessed Value: \$8300

Town & County Taxes: \$200

NOTE: Taxes DO NOT include re-leivies.

Inspection: Drive by Anytime

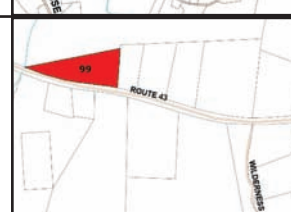

COUNTY OF RENSSELAER, NY REAL ESTATE AUCTION

TERMS AND CONDITIONS OF SALE

PARTIAL AUCTION TERMS - SEE BIDDER APPLICATION AND WEBSITE FOR ADDITIONAL DOCUMENTS AND INFORMATION

By electronically or manually signing this certification and submitting along with all documents related to the Online Bidder Application, in exchange for bidding privileges, I hereby certify under penalty of perjury the following: This contract and all related documents should be reviewed by your counsel prior to bidding as it contains terms and requirements which are not subject to modification, bid withdrawal, or bid cancellation. By bidding on any property being offered for auction, you acknowledge that you have either: (1). reviewed the contract with your attorney or, (2). waived right of attorney review. Further note that failure of purchaser to secure financing prior to date of transfer does not constitute grounds for an extension or return of the Down Payment, Buyer's Premium, and additional fees.

1. The property(s) offered for sale has/have been acquired by the County of Rensselaer (hereinafter referred to as the "County") by Court Order pursuant to the provisions of Title 3, Article 11 of the Real Property Tax Law of the State of New York.
2. All potential Bidders/Buyers must BECOME A MEMBER WITH COLLAR CITY AUCTIONS, INC., (hereinafter referred to as the Auction Company) at www.collarcityauctions.com.
3. All Bidders/Buyers must register for this auction and submit all required Bidder Application documents and then will be manually approved to bid once Bidder Application has been received, reviewed, and approved by the Auction Company. **Registration will be available Friday, November 21, 2025, through Tuesday, December 16, at 1:00 PM. LATE REGISTRATIONS WILL NOT BE ACCEPTED NOR APPROVED ONCE REGISTRATION HAS CLOSED ON OUR WEBSITE.**
4. Former owners and immediate family members will not be allowed to bid on their properties. No third parties shall be allowed to bid on behalf of the former owner.
5. By acknowledging and executing these Terms & Conditions, the purchaser certifies that he/she/they is not representing the former owner(s) of the property against whom the County foreclosed tax liens and has no intent to defraud the County of the unpaid taxes, assessment, penalties, and charges which have been levied against the property. The purchaser agrees that neither he/she/they nor his/her assigns shall convey, transfer, or assign the property to the former owner(s) against whom the County foreclosed within 24 months subsequent to the auction date. If such conveyance occurs, the purchaser understands that he/she/they will be found to have committed fraud, and/or intent to defraud, and will be liable for any deficiency between the purchase price at auction and such sums as were owed to the County for unpaid taxes prior to the tax lien foreclosure on the property and consents to immediate judgment by the County for said amounts in addition to reasonable attorney's fees and expenses.
6. NO PERSON OR ORGANIZATION CAN BID ON PROPERTIES WITHIN THE AUCTION IF THEY, OR A CORPORATION OR COMPANY THEY ARE AFFILIATED WITH HAVE ONE OR MORE YEARS OF DELINQUENT TAXES OWED TO THE COUNTY. ALL SUCH TAX LIABILITIES MUST BE PAID PRIOR TO THE AUCTION IN ORDER TO BID AT THE AUCTION.
7. The property will be conveyed by the County to the purchaser by quit-claim deed, containing a description of the property known as tax map number and as it appears on the tax roll for the year upon which the County acquired title or as corrected up to the date of deed. The deed will be recorded by the County upon payment in full of the purchase price and all transfer fees/costs. POSSESSION OF PROPERTY IS FORBIDDEN UNTIL THE DEED IS RECORDED WITH THE RENSSELAER COUNTY CLERK CONVEYING TITLE TO THE PURCHASER. TITLE VESTS AT THE RECORDING OF THE DEED. It is agreed between the County and the purchaser that delivery and acceptance of the deed occurs upon recording of the deed, which shall constitute the transfer of legal title of the premises to the buyer.
8. The County will not furnish an abstract of title or an instrument survey map.

9. The County does not make any representations or warranties, expressed or implied, (a) concerning the quality or the condition of the title to the property, or the validity or marketability of such title; the ownership of any improvements on the property; the condition of the property and any improvements thereon or its fitness for any use; or the accuracy of the property description on the tax roll or in the notice of sale or any other advertisement of sale furnished by the County; or (b) that the property or any improvements thereon presently comply with building or zoning codes, or with any state or local laws or regulations. Any information concerning the property furnished by the County or any of its officers, employees, or agents shall not be deemed to include any such representations or warranties. Any promotional tools such as photographic slides, tax maps, written or verbal descriptions, etc. are for informational purposes only.
10. Any successful bidder who fails to tender the deposit as outlined or fails to close on the parcel(s) that he/she/they bid on at auction, will be forbidden to participate in this or any other auction for a time period of 24 months. Any parcels where the deposit was not received at the close of the auction contract completion date will be considered defaulted.
11. **I acknowledge that I have received a complete bidder registration application and will not be approved to bid until the Auction Company has received my fully completed Online Bidder Application and Credit/Debit Card Contractual Agreement.**
12. As specified in the "Online Bidder Application," I unconditionally acknowledge, agree, and authorize the Auction Company to place a \$1,000.00 hold on my credit or debit card (**NO PREPAID CARDS OR AMERICAN EXPRESS ACCEPTED**) which will be released if I am not the successful bidder or you may include an official bank check made payable to COLLAR CITY AUCTIONS, INC. PERSONAL AND/OR BUSINESS CHECKS WILL NOT BE ACCEPTED. Non-winning bidders will receive a full refund in 10-business days post auction without any accrued interest. If your credit or debit card hold is not released, you must contact your credit card company or financial institution as we auto release them post auction. ANY HOLD-UP IS DUE TO YOUR CREDIT CARD COMPANY OR FINANCIAL INSTITUTION. Winning bidders will have the credit or debit card hold released upon completion of the purchase and sale contracts and all required monies have been received by the Auction Company. The hold is required to be approved to obtain bidding privileges and will only be converted to a fully executable charge and retained if the successful high bidder does not perform and complete the required purchase contracts and addendums by appointment on **Monday, January 5 or Tuesday, January 6, 2026, 9:30 AM – 4:00 PM**, at our offices located at 9423 Western Tpke., Delanson, NY 12053, or if the bidder is non-responsive, or if the bidder informs the Auction Company or County that they are not following through with their contractual obligations verbally or in writing. I further unconditionally pre-authorize and grant permission to the Auction Company to charge my credit or debit card in full or part for all amounts, plus a \$750.00 default fee due if I default in any contractual obligations herein and forever forgo any and all rights to place a chargeback or dispute on any charge placed on my credit or debit card related to my obligations agreed to herein as well as contained in the Online Bidder Application Credit/Debit Card Agreement and/or other auction related documents. If I attempt or do place any chargeback, file a dispute, or claim of any kind, or attempt to cancel any hold or charge of fees due now or in the future, I unconditionally and formally grant the Auction Company pre-authorized permission to charge all monies due in full or increments as available. I further acknowledge, pre-authorize, and instruct my credit card company or financial institution that if I file a dispute, chargeback, or any claim to block, reverse, or cancel any charge or hold placed by the Auction Company or the County that it is not valid. I further instruct and grant unconditional authorization and permission to my credit card company or financial institution to void my chargeback, dispute, or requests of any kind now and forever. Additionally, I grant the Auction Company permission to charge my credit or debit card now or at any time in the future an additional recovery fee, in full or increments, the amount of \$750.00 to cover their time involved with answering any chargeback, dispute, or claim now or in the future. **I acknowledge that my credit or debit card information provided within my Bidder Registration Application is valid, current, accurate, and provided for manual keyed input or online processing regardless of if it is a chipped card.** I also acknowl-

PARTIAL AUCTION TERMS - SEE BIDDER APPLICATION AND WEBSITE FOR ADDITIONAL DOCUMENTS AND INFORMATION

edge and agree to reimburse the Auction Company and County all time at \$475.00 per hour, legal expenses, attorney fees incurred if I cause any action, litigation or any claim that would cause these types of fees to be incurred. I further agree not to close or block any credit or debit card in an attempt to prevent fees due from being charged to my credit or debit card. I unconditionally acknowledge and agree that upon registering and entering my name and credit or debit card information into the Auction Company's registration process that I am electronically signing and personally guaranteeing that I have read, fully understand, and agree to abide by and be bound by all related terms and related auction documents and their content. I agree to be fully responsible for all associated costs involved with the resale, remarketing, and any deficiency if I default and the Auction Company and County must resell any property(s) due to my default. I agree that if I bid on multiple properties, these terms and all fees apply individually to each separate parcel.

13. I have read and agree to be bound by all terms herein as well as contained in the County of Rensselaer, NY Tax Property Online Bidder Registration Application and fully and unconditionally understand and agree to abide by and be bound to them without exception.

14. By registering, I acknowledge I have sufficient funds to meet all requirements as called for by the terms within the Online Bidder Application as well as the purchase agreement post auction. I agree to be fully responsible for all collection costs, plus reasonable attorney fees related to any and all collection costs incurred by the County or Auction Company if I default and fully understand that litigation between the County and any bidder or buyer will only be brought forth in Rensselaer County Supreme Court and any litigation between the Auction Company and any bidder or buyer shall only be brought forth in Schenectady County Supreme Court, unless otherwise brought forth by the Auction Company against the bidder. In this case the jurisdictional court will be selected solely by the Auction Company.

15. Upon being declared the high bidder of a parcel, the Bidder as Purchaser will be contacted by the Auction Company to schedule an appointment to execute the Contract of Sale Packet and remit the required Down Payment of 10% of the bid price plus 10% Buyer's Premium, \$150.00 Processing/Search fee, and 1.5% Advertising Fee per property based on the total on bid amount. Appointments will take place on **Monday, January 5 or Tuesday, January 6, 2026, 9:30 AM – 4:00 PM**, at the Auction Company offices, located at 9423 Western Tpke, Delanson, NY 12053. If a bid price is \$1,000.00 or less, the Bidder as Purchaser will be required to pay in full the bid price, Buyer's Premium, and all other required fees/costs at time of contract completion. **All monies must be paid in Cash, Official Bank Check or Cashier's Check. Cashier's Checks for Buyer's Premium and Processing/Search fee must be payable to COLLAR CITY AUCTIONS, INC. and drawn on banks insured by the Federal Deposit Insurance Corporation (FDIC) or National Credit Union Association (NCUA). Cashier's Checks for down payments must be payable to RENSSELAER COUNTY BUREAU OF FINANCE and drawn on banks insured by the Federal Deposit Insurance Corporation (FDIC) or National Credit Union Association (NCUA). Credit Cards, Personal, or Business Checks will NOT be accepted for paying the down payment, Buyer's Premium or Advertising Fee unless I/We, the bidder as purchaser defaults on any of my obligations herein.**

16. The property will be sold as advertised and "AS IS" with absolutely no warranty or guaranty, expressed or implied. I agree to accept the property in "AS IS" condition with all faults as defined in the Auction Rules and Sales Contract. No representations of any kind are or have been made by the Auction Company, the County, or their agents as to the title or physical condition of the property or as to the existence of any improvements thereon including water/well and sewer/septic systems. The sale of these properties is pursuant to a purchase contract. Failure of purchaser to secure financing prior to date of transfer does not constitute grounds for an extension or return of the down payment or Buyer's Premium. All information contained in the Auction Brochure, contained within the website of the Auction Company, and contained in the Online Bidder Registration Application is supplied for informational purposes only and not guaranteed. Prospective purchasers are urged to fully research any property prior to bidding at auction. Furthermore, all parties agree to hold harmless the County, Auction Company, and their agents from any errors and/or omissions, injury and/or other matter that may arise now or in the future.

17. I am an eligible buyer as defined in the Auction Terms, Online Bidder Registration Application and Sales Contract Packet.

18. (a) I am not the prior owner of any of the properties being offered for auction.

(b) I am not an immediate family member of a prior owner:

(c) I am not in any way acting on behalf of, as an agent of, or as a representative of the prior owner.

(d) I am not acting as an agent of any officer, stockholder of a corporation or general or limited partner of a partnership which owns any of the properties being offered for sale.

(e) I do not own property in the County of Rensselaer, either individually, jointly with another, through a corporation or partnership, which has one or more years of delinquent taxes, **or has had property foreclosed by Rensselaer County due to property taxes not being paid within the past five years.**

(f) I am not acting on behalf of, as an agent of, or a representative of any of the persons or entities set forth herein or above.

(g) In accordance with the requirements and prohibitions set forth in Article 18 of the General Municipal Law, sitting members of the Rensselaer County Legislature are precluded from bidding on any parcels included in the auction. Members of the Town Boards for each Town in the County of Rensselaer are precluded from bidding on any parcels located in their respective Towns. I am not an elected or appointed official, (nor the spouse, minor child or dependent, thereof) involved in the assessment, tax levy, budget making or tax rate setting process in any municipality in the County of Rensselaer, including but not limited to Assessors, Board of Review Members, Town Board Members, and Town Supervisors, Village Trustees, Village Mayor, County Bureau of Finance, County Attorney, County Legislators, County Clerk and County Real Property Tax Director.

(h) I have not defaulted from the prior **TWO** years' County of Rensselaer Delinquent Tax Auctions. That by submission of a bid, each bidder and each person signing in person or electronically on behalf of any bidder certifies, and in the case of a joint bid, each party thereto certifies that to the best of their knowledge and belief: The prices in a bid have been arrived at independently without collusion, consultation, communication, or agreement for the purpose of restricting competition as to any matter relating to such prices with any other bidder or with any competitor.

19. I understand that in the event that I refuse or fail to complete my contractual obligations as a successful high bidder or if I fail to consummate purchase of any parcel at an auction, the next highest bidder of that parcel, at the discretion of the County, shall be offered the opportunity to purchase the parcel at the amount of the next highest bid plus the Buyer's Premium, 1.5% Advertising fee, closing costs/fees, \$150.00 Processing/Search fee, and such other amounts as are due under these terms and conditions of sale. Secondary sale is not grounds for any refund or release of performance obligations to initial bidder as purchaser.

20. I understand and agree that if at any time prior to the recording of the deed, the County determines that the Buyer is one of the persons set forth in paragraph 4, 5, 6 and 18 herein, the County at its sole option shall declare the public online auction sales contract breached and the County shall retain any and all down payments made, and the Buyer shall forfeit all Buyer's Premium to the Auction Company paid or due and owing. I understand that if I am an elected official bidding on tax property within the local government jurisdiction that I serve, knowingly entering into a purchase contract is in violation of state law and may subject me to criminal and/or civil penalties including but not limited to forfeiture of deposits, purchase price, Buyer's Premium, \$150.00 Processing/Search fee and title to the subject property.

21. I agree to hold the Auction Company, the County, and their agents and/or principals to the extent permitted by law, harmless from any claims based on environmental hazards that may be present on any property I purchase. No representations have been made or will be made by the County as to the environmental condition or zoning compliance of the property.

22. I have received a copy of the pamphlet Protect Your Family from Lead in Your Home and I waive the opportunity to conduct a risk assessment or inspection for the presence of lead-based paint and/or lead-based paint hazards.

23. I understand that only bids made by clearly using my user identification/user screen name will be accepted and that the bidding process will be recorded.

24. All parcels purchased by a Buyer must be paid in full. Selective closings

PARTIAL AUCTION TERMS - SEE BIDDER APPLICATION AND WEBSITE FOR ADDITIONAL DOCUMENTS AND INFORMATION

are not permitted. Failure to remit full payment on all parcels purchased at the auction will result in a forfeiture of all monies paid, which will be retained by the County and Auction Company as liquidated damages, and the cancellation of all sales to the Buyer.

25. All tax properties sold at auction are being sold subject to:
- (a) Rights of the public and others in and to any part of the premises that lies within the bounds of any street, alley, or highway.
 - (b) Manufactured home, mobile home, or trailer liens, if any.
 - (c) All covenants, leases, easements, and restrictions of record affecting said premises, if any.
 - (d) Any state of facts that an accurate, currently dated survey might disclose.
 - (e) Environmental conditions of property.
 - (f) All New York State and Federal tax liens, if any.
 - (g) All taxes due as applicable and disclosed on the date of the auction. It is understood that these taxes may not be exact and owing.
 - (h) Village tax liens, if any.
 - (i) Purchasers are not responsible for taxes listed on the current Rensselaer County Delinquent Tax Statement.

26. The property being sold may be subject to tenancies and/or leases affecting the said property. The Buyer is to determine the existence and status of such interests and the applicable legal rights there to. **Evictions, if necessary, are solely the responsibility of the Buyer after the recording and receipt of the deed.**

27. The total Bid Price is the combination of the high bid, the Buyer's Premium, advertising fee, and all applicable fees to include the \$150.00 Processing/Search fee. The buyer shall enter into the required non-contingent purchase and sales agreement. All sales shall be final, absolute and without recourse. In no event shall the County or Auction Company be or become liable for any defects in title for any cause whatsoever and no claim, demand or suit of any nature shall exist in favor of the purchaser, its heirs, successors, or assigns against the County arising from this sale. In the event the County for any reason determines not to sell to the purchaser the property bid on at auction, the purchaser shall be refunded the total bid price paid or 10% down payment, whichever is applicable, Buyer's Premium and Processing/Search fee without any accrued interest. The County of Rensselaer is only accepting payments from Monday, January 12, 2026, through Wednesday, January 14, 2026, at 2:30 P.M. IF THE BALANCE DUE FROM BUYER(S) PLUS ANY ADDITIONAL CHARGES ON EACH PROPERTY PURCHASED AT THE AUCTION IS NOT RECEIVED IN FULL BY THE COUNTY OF RENSSELAER, ON OR BEFORE WEDNESDAY, JANUARY 14, 2026, BY 2:30 P.M. AT THE RENSSELAER COUNTY FINANCE OFFICE, 99 TROY RD, EAST GREENBUSH, NY, THE BUYER(S) SHALL IMMEDIATELY FORFEIT THEIR DOWN PAYMENT OR ANY PAYMENTS MADE WITHOUT RECOURSE AND THE PURCHASE AND SALE AGREEMENT SHALL BECOME NULL AND VOID FOR ANY OBLIGATION THE COUNTY HAD TO PURCHASER. Purchaser agrees and understands that the Buyer's Premium and \$150 Processing/Search fee are deemed earned by the Auction Company and the County, respectively, upon approval or acceptance of the bid by the COUNTY and are non-refundable. This means when you become the successful high bidder. A sample Purchase and sale agreement is available online at www.collarcityauctionsonline.com or call our office at 518-895-8150 to request a sample be sent via USPS if you do not have internet access. No internet access? You may also place a bid utilizing our "Absentee Bid Form Contained within the "Online Bidder Application."

28. Notice is hereby given that the premises being sold may lie within an Agricultural District as designated upon the tax map. It is the sole responsibility of any bidder to ascertain which specific parcel(s) is so designated and thereby sold subject to the provisions of law applicable thereto.

29. The purchaser must pay the balance of the purchase price and all of the required recording taxes and fees (cash, certified check, or bank check) no later than **2:30 P.M. on JANUARY 14, 2026**. Certified and bank checks must be made payable to the Rensselaer County Bureau of Finance. Upon receipt of the required payment the deed will be recorded in the County Clerk's Office and mailed to the purchaser upon completion of the recording process. The purchaser may not assign his/her right to complete the sale. **ALL DEEDS SHALL BE EXECUTED SOLELY IN THE NAME OF THE BIDDER AS REGISTERED AT TIME OF REGISTRATION.** If the purchaser fails to make such payments on or before **JANUARY 14, 2026**, the sale shall be deemed cancelled. The County and Auction Company shall not be obligated to convey the property to the purchaser and the purchaser's

deposit shall be retained by the County as liquidated damages.

30. The transfer costs/fees which the purchaser shall be required to pay to the County, in addition to the bid price, shall consist of:
- (a) Filing fee for the Real Property Transfer Report (RP-5217) of \$125.00 if the property is classified as agricultural (100's), 1-3 family dwelling or condominium (411-c), and \$250.00 if the property is otherwise classified (vacant (300's), apartment, commercial, entertainment, community service, industrial, public service, forest, etc).
 - (b) Filing fee for combined Capital Gains Transfer Tax Affidavit, \$5.00.
 - (c) All other fees and surcharges required by the Rensselaer County Clerk for recording of the deed, \$50.00
 - (d) Processing/Search Fee, \$150.00
 - (e) Notice of Sale Fee for Class Codes of 1-4 family to include apartment buildings and condominiums, \$10.00

31. Property Inspections: Please drive by vacant land parcels. Improved properties may ONLY be inspected from the exterior. Please do not enter any improved properties. Please ONLY Drive by Occupied Properties. If an improved property appears to be occupied, you are only permitted to view from the road.

32. Purchasers are not responsible for taxes listed on the current Rensselaer County Delinquent Tax Statement. Purchasers will, however, be responsible for the 2026 Rensselaer County Property Tax Bill to include any relevy amounts associated with the 2025-2026 School Tax Bill and, if applicable, the June 2025 Village Tax Bill.

33. In order to avoid future delinquent charges, the new owner should immediately advise all tax collectors of the new ownership, and the address where future tax bills are to be mailed.

34. The County reserves the right to sell to the next highest bidder if Purchaser defaults without further notice to first bidder.

35. The County reserves the right to accept or reject any or all bids, or to withdraw any parcel from the sale at any time prior to delivery of the deed to the purchaser.

36. In the event that a sale is cancelled by Court Order, judgment, or by the Rensselaer County Legislature, the successful bidder shall be entitled only to a refund of the purchase money. Purchaser shall not be entitled to special or consequential damages, attorney fees, reimbursement for any expenses incurred as a result of ownership or improvements of the property, or for taxes paid during the period of ownership.

37. No personal property is included in the sale of any property and/or parcel(s) owned by the County. The disposition of any personal property located in, under or on the property or parcel sold shall be the sole responsibility of the purchaser upon transfer of title.

38. Notice to Real Estate Brokers/Agents: The Auction Company is acting in the capacity of a Real Estate Broker/Auctioneer and NOT as a Realtor on the auction of the properties contained herein. The Auction Company is NOT offering any cooperating brokerage fee to any outside brokerage company or agent for producing a bidder or purchaser at this auction. It is recommended that Brokers and/or Agents structure some type of compensation from the buyer they are representing.

- I, the Bidder, acknowledge that I read, write, and fully understand the English language and further agree and acknowledge that I have fully read and, if necessary, reviewed all terms/bidder registration documents related to bidding and purchasing with my counsel. I further acknowledge that all information is true and accurate under penalties of law.

Bidder(s) acknowledges all documents are electronically signed and legally binding via DocuSign.

Print Name

Signature

Date

Print Name

Signature

Date

Rensselaer County Real Estate Auction Contract of Sale

Purchaser: John Q. Public
Address: 1 Main Street
City: Anytown, NY 00000
Phone: 000-000-0000

Bidder Number: 1
SS#/Fed ID Number: _____

I hereby agree to purchase the property known as Auction Lot No: 1 located in the Town of Berlin, Tax Map No: XXX.XX-XX-XX and agree to pay the bid price of \$50,000.00, plus the 10% Buyer's Premium of \$5,000.00, 1.5% Advertising fee of \$750.00, and \$150.00 Processing/Search fee together with closing costs, property, village and school tax, if applicable, for the said property on the terms contained in the TERMS AND CONDITIONS OF THE SALE, signed by and agreed to by me and made part of this contract. I (we), the Buyer(s), will sign along with this Contract of Sale, and all other applicable Auction documents.

It is understood and agreed that the conveyance will be by QUIT CLAIM DEED to be executed subsequent to receipt of all money due in accordance with the TERMS AND CONDITIONS OF SALE.

I have deposited with Rensselaer County Treasurer's Office the sum of \$5,150.00 which represents \$5,000.00 down payment to apply to the purchase price and an additional \$150.00 Processing/Search fee. Additionally, I unconditionally acknowledge payment and release of the full non-refundable buyer's premium to the Auction Company, for its sole use, auction day. The down payment, Processing/Search fee, Advertising fee, and buyer's premium shall be forfeited as liquidated damages if the PURCHASER fails to comply with the TERMS AND CONDITIONS OF THE SALE as indicated therein.

By signing, I unconditionally agree that I have reviewed all information herein including, but not limited to my name and spelling of name and acknowledge it to be correct.

Buyer: John Q. Public

Buyer:

Social Security #/Federal ID

Social Security #/Federal ID

.....

THE FOLLOWING IS FOR OFFICIAL USE ONLY – DO NOT COMPLETE

Bid Price:	_____	\$50,000.00
RP-5217 Filing Fee:	_____	\$ 125.00
County Clerk Recording Fee:	_____	\$ 50.00
Gains Transfer Tax Fee:	_____	\$ 5.00
Processing/Search Fee:	_____	\$ 150.00
Notice of Sale Fee:	_____	\$ 10.00 * this fee only applies to specific class codes

SUB – TOTAL:	_____	\$50,340.00
Less Monies Paid Down:	_____	\$ 5,150.00

Total Due by: January 14 2026, in cash or bank check: \$45,190.00

Sample Purchase Transaction

Money Due at Contract Signing with Cash or Cashier Check Payment

\$50,000 Purchase/Bid Price

\$ 5,000.00 Down Payment (10%)

\$ 5,000.00 Buyer's Premium (10%)

\$150.00 Processing/Search Fee

\$750.00 Advertising fee (1.5%)

\$ 10,900.00 Due Auction Day

Monies Due:

\$50,000.00 Purchase/Bid Price

\$ 5,000.00 Down Payment (10%)

\$45,000.00 Due at Closing PLUS*

\$1,000 Purchase/Bid Price

\$ 1,000.00 Down Payment

\$ 100.00 Buyer's Premium (10%)

\$ 150.00 Processing/Search Fee

\$ 15.00 Advertising fee (1.5%)

\$ 1,265.00 Due Auction Day as Purchase Price in Full**

Monies Due:

\$ ZERO Purchase/Bid Price

See Below*.

***Samples Do Not Include Applicable Closing/Transfer Costs Due and Payable to County Post Auction.**

***Applicable Additional Costs Due No Later than January
14, 2026 as specified in Auction Terms and Conditions.**

****All Bids of \$1,000.00 or less require full payment Auction
Day consisting of Bid Price, Buyer's Premium, Advertising
fee, Processing/Search fee, and ALL Other Applicable
Closing/Transfer Costs.**

The closing/transfer costs/fees which the purchaser shall be required to pay, in addition to bid price, shall consist of:

- a) Filing fee for the Real Property Transfer Report (RP-5217) of \$125.00 if the property is classified as agricultural (100's), 1-3 family dwelling or condominium (411-c), and \$250.00 if the property is otherwise classified (vacant (300's), apartment, commercial, entertainment, community service, industrial, public service, forest, etc);
- b) Filing fee for combined Gains Transfer Tax Affidavit, \$5.00;
- c) All other fees and surcharges required by the Rensselaer County Clerk for recording of the deed, \$50.00;
- d) Notice of Sale fee for Class Codes of 1-4 family to include apartment buildings and condominiums, \$10.00.



Licensed & Bonded Auctioneers, Realtors, Certified Appraisers and Consultants

9423 Western Turnpike

Delanson, NY 12053-2105

GLOBAL AUCTION, REAL ESTATE, CERTIFIED APPRAISAL AND CONSULTING SOLUTIONS

REAL ESTATE AUCTION

"PLEASE RUSH"
TIME DATED MATERIAL

66±

**SINGLE FAMILY, MULTI-FAMILY,
MANUFACTURED HOUSING,
RURAL & RESIDENTIAL
VACANT LAND**

ONLINE REAL ESTATE AUCTION



**IT'S HERE IN
RENSSELAER**
EXPLORE RENSSELAER COUNTY

**SINGLE FAMILY, MULTI-FAMILY,
MANUFACTURED HOUSING,
RURAL & RESIDENTIAL VACANT LAND**

66± RENSSELAER COUNTY, NY - TAX FORECLOSED PROPERTIES

BEGINS ONLINE: FRIDAY, NOVEMBER 21, 2025

REGISTRATION CLOSING: TUESDAY, DECEMBER 16, 2025, 1:00 PM

BIDS BEGIN CLOSING: THURSDAY, DECEMBER 18, 2025, 11:00 AM (ET)

SEE WEBSITE FOR COMPLETE DETAILS AND BIDDER REGISTRATION APPLICATION

REGISTER ONLINE AT www.CollarCityAuctions.com